

Montalvo

PB-Series

Magnetic Particle Brakes

montalvo

Better Web Control®

NEW

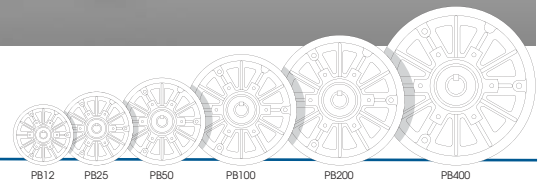

Montalvo PB-Series Magnetic Particle Brakes

High performance magnetic particle brake for quiet, clean, low torque tension control applications.

Features

- ▶ Shafted brake to fit a variety of applications
- ▶ Ambient cooled - optional forced air cooling available
- ▶ For use in tension applications requiring:
 - Stop
 - Static Braking
 - High-Frequency
 - Positioning
 - Clean Room / Dust Free

NEW

Dimensions

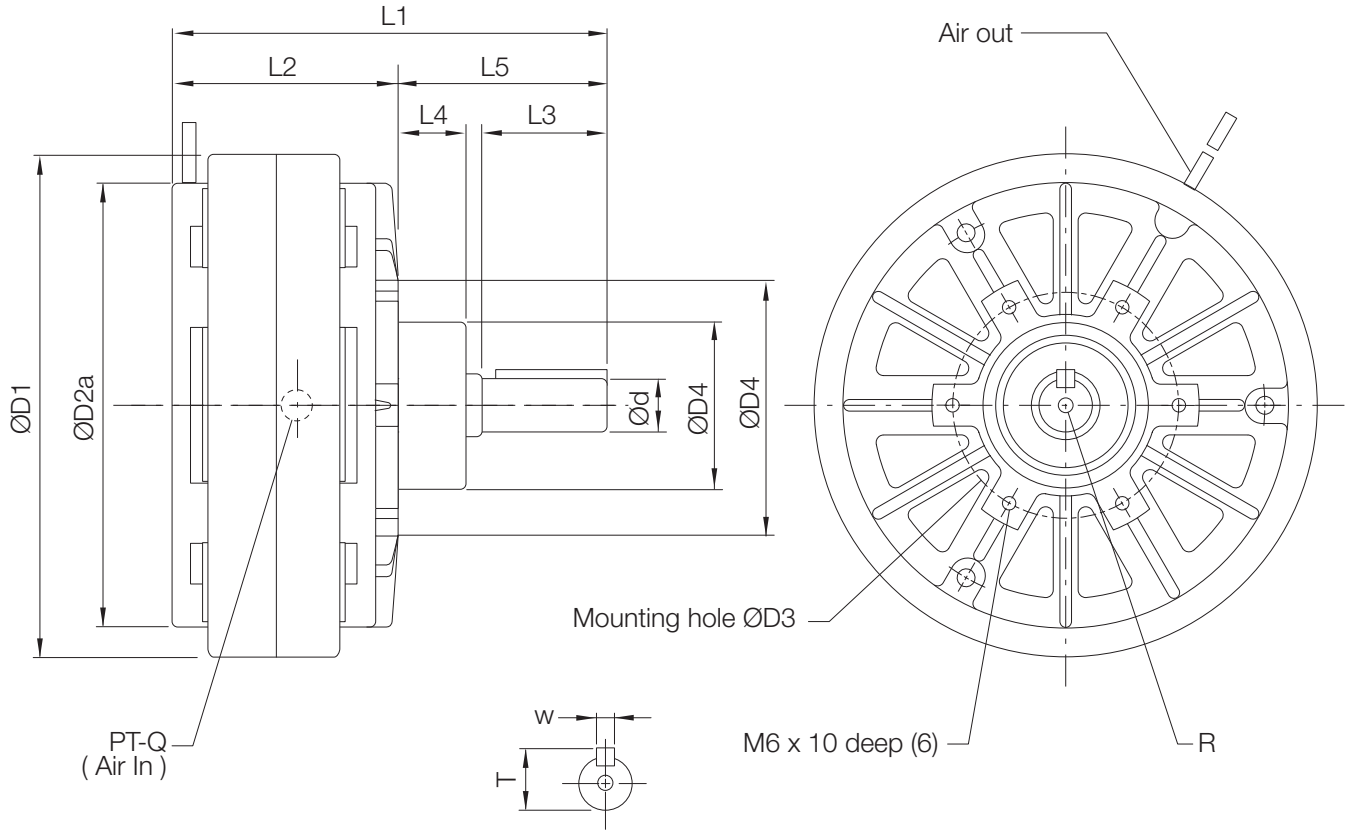

Size	L1	L2	L3	L4	L5	D1	D2a	D2a	D3	D4(g7)	Q(inch)	R	d(h7)	W(p7)	T(0-0.2)
PB12	132	83	29	15	49	152	126	-	64	42	1/8	M4 x 8 deep	15	5	17
PB25	155	91	43	17	64	184	160	-	78	55	1/8	M5 x 10 deep	20	5	22
PB50	193	102	55	30	91	219	196	-	100	74	1/4	M8 x 12 deep	25	7	28
P100	239	139	65	28	100	278	-	160	140	100	3/8	M10 x 20 deep	30	7	33
PB200	278	169	69	30	109	327	-	174	150	110	3/8	M10 x 20 deep	35	10	38.5
PB400	339	200	92	35	139	398	-	230	200	130	3/8	M10 x 20 deep	45	12	48.5

Details

Installation

- Use a flexible elastic shaft coupling when connecting brake to application roll
- Check for concentricity and squareness
- Installation of belt wheel or gear must equal input and output axis
- Do not exceed concessional axis end weight range

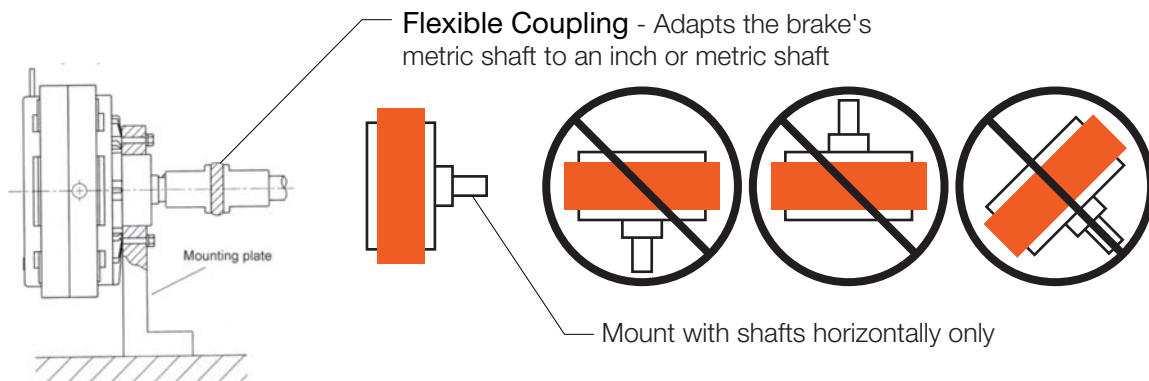

Torque

- Proportional to input current
- Independent of RPM
- While load torque is less than output torque, shaft won't rotate
- When load torque is increased, brake will slip smoothly at torque level set by coil input current
- With no electrical excitation, shaft freely rotates
- With electrical excitation, shaft becomes coupled to the case

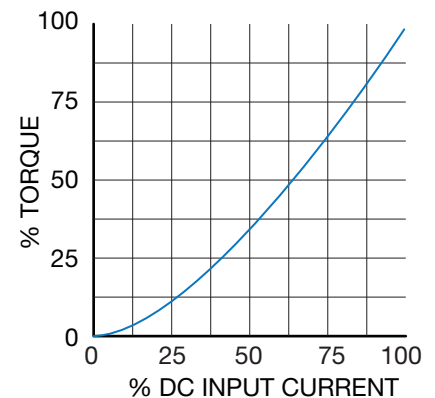

Cooling

Compressed air

- Clean, dry compressed air may be used to increase cooling
- Case has BSPT threaded port
- Solid shaft brakes only

Fan assisted

- Optional
- Same performance as compressed air

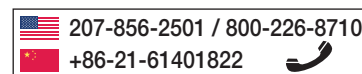

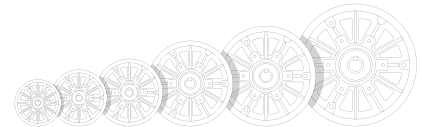

Torque

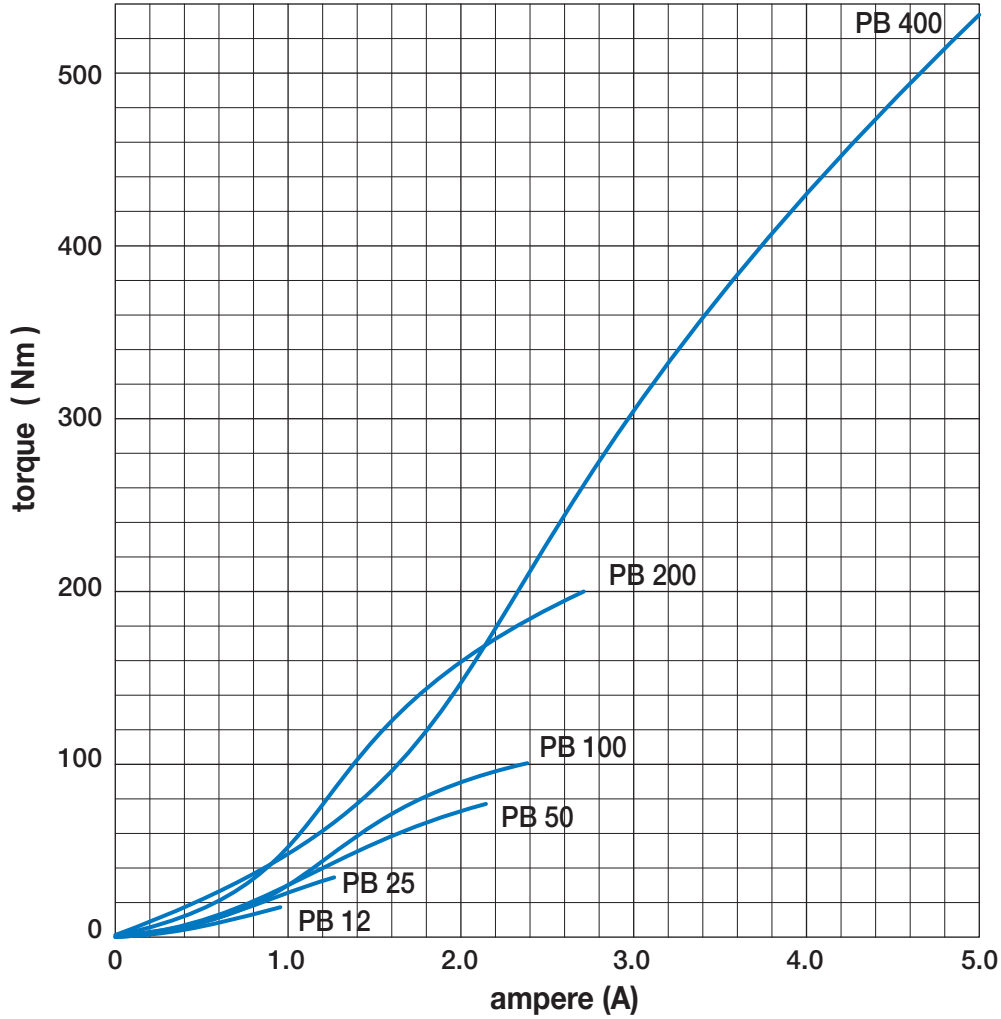

Specifications

Model	PB12	PB25	PB50	PB100	PB200	PB400
Torque Nm (in-lb)	12 (106)	25 (221)	50 (443)	100 (868)	200 (1735)	400 (3471)
Standard voltage (VDC)	24	24	24	24	24	24
Capability (75°C)						
Electric	0.94	1.24	2.15	2.40	2.70	5
Electric power (W)	22.5	30	51.5	57.6	64.8	120
Reaction time (S)	0.10	0.12	0.13	0.25	0.37	0.40
Weight kg (lb)	4.8 (10.6)	7.9 (17.4)	14.5 (32)	34 (75)	53 (117)	102 (225)
Max. RPM	1,800	1,800	1,800	1,800	1,800	1,800
Ratio (g)	20	33	60	140	225	300
Heat Dissipation						
At 100 RPM (W)	-	130	190	300	425	550
At 1000 RPM (W)	-	175	275	500	800	1200
With Cooling (compressed air or fan) (W)	-	260	425	800	1200	1900
Compressed Air Pressure (lb-in ²)	-	4	5	9	7	21
Flow Rate (cfm)	-	6	7	10	6	14