

Guardian

Safety Chucks

**Montalvo Guardian Safety Chucks**

The newly designed Guardian Safety Chucks feature longer service life, easier roll loading and lowest total cost of ownership in the industry. Heavy duty bearings and redesigned handwheel ensures maximum load and speed capacities. A new redesigned journal seat with hardened replaceable inserts (A2 and A3) not only reduces maintenance and increases service life but reduces overall costs. Fixed or sliding shaft models combined with numerous options makes the Guardian line of chucks suitable for practically any application.

Features

- ▶ Available in A1 (Square), A2 (Diamond) or A3 (Triangle) journal seat types
- ▶ Hardened replaceable journal seat inserts (A2 and A3)
- ▶ Easier roll loading for operators
- ▶ Longer service life
- ▶ Built to suit customizable shaft ends
- ▶ Self centering journal seats (A2 and A3)
- ▶ Available with pre-installed Montalvo brake
- ▶ Lowest total cost of ownership
- ▶ Backward compatible with KL Series Safety Chucks



Specifications

Individual drawings of all models are available on request in dwg, dxf or pdf format.

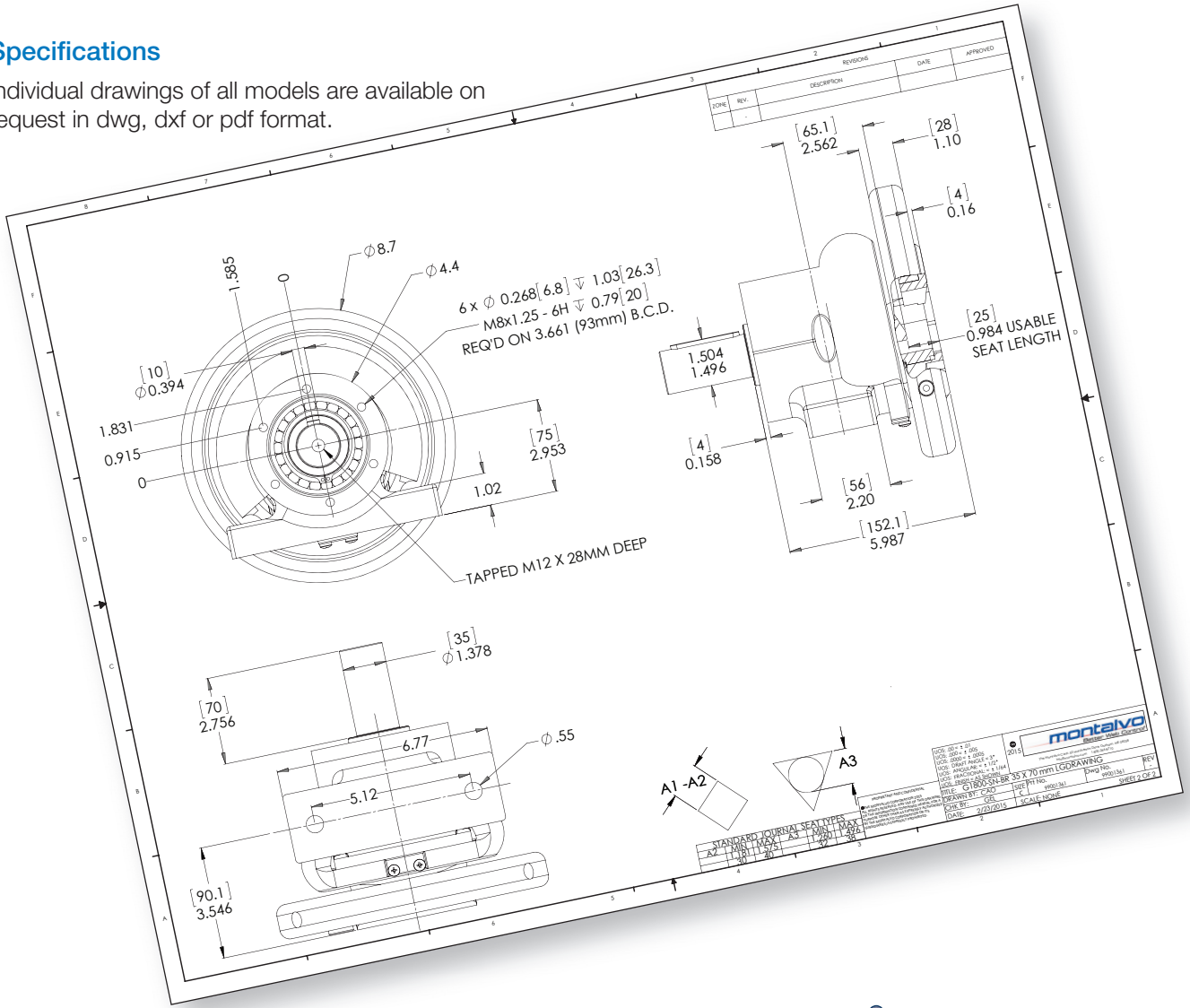

Chuck Capacity & Journal Dimensions

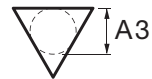
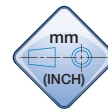

Model	Max. Shaft Extension mm (in.)	A1 (Square) Journal Seat			A2* (Diamond) Journal Seat			A3 (Triangle) Journal Seat		
		Max. Roll Weight N (lb)	Max. Torque Nm (in-lb)	A1 Dimensions mm (in)	Max. Roll Weight N (lb)	Max. Torque Nm (in-lb)	A2* Dimensions mm (in)	Max. Roll Weight N (lb)	Max. Torque Nm (in-lb)	A3* Dimensions mm (in)
G1000	ϕ 35k6 x 90 (3.54)	10,000 (2,248)	200 (1,770)	20-30 (1.000-1.25)	7,000 (1,574)	100 (885)	20-30 (1.000-1.25)	10,000 (2,248)	200 (1,770)	20-30 (0.787-1.181)
G1800	ϕ 50k6 x 100 (3.94)	18,000 (4,047)	380 (3,363)	30-40 (1.25-1.50)	12,600 (2,833)	190 (1,682)	30-40 (1.25-1.50)	18,000 (4,047)	380 (3,363)	32-38 (1.260-1.496)
G3000	ϕ 65k6 x 140 (5.51)	30,000 (6,744)	1,200 (10,621)	40-50 (1.50-2.00)	21,000 (4,721)	600 (5,310)	40-50 (1.50-2.00)	30,000 (6,744)	1,200 (10,621)	40-47 (1.575-1.850)

* Safety Locks standard on chucks with A2 journal seats.

NOTE: Safety Locks required for turret applications.

Normal Safety Chucks

Pedestal Mount (SN)

Available for all models

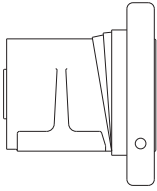

Without Shaft End

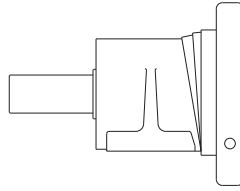

With Shaft End

Flange Mount (FN)

Available for all models (G-3000 shown)

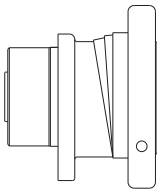

Without Shaft End

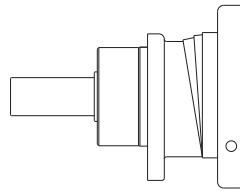

With Shaft End

Sliding Safety Chucks

Pedestal Mount (SS)

Available models G-1800

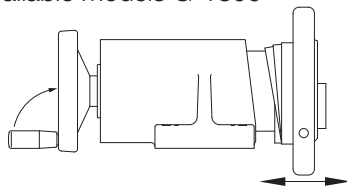

Hand Wheel Drive

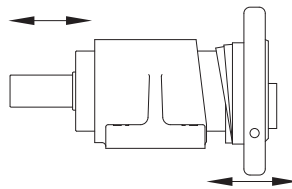

Sliding Shaft End

Flange Mount (FS)

Available model - G-1800 (shown)

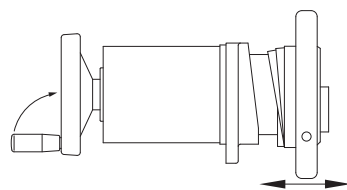

Hand Wheel Drive

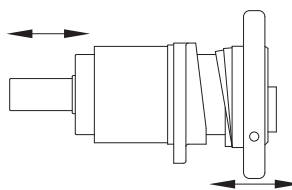

Sliding Shaft End

← → Represents 50 or 100 mm Axial Adjustment

Journal Seat Types / Advantages

Types / Advantages

Available for all models

A1 (Square)



Max. reel weight capacity
 Max. torque capacity
 Cost effective

A2 (Diamond)

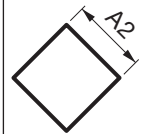

Easy loading
 Less vibration

A3 (Triangle)



Max. reel weight capacity
 Max. torque capacity
 Easy loading
 Less vibration
 Optimal at higher rpm

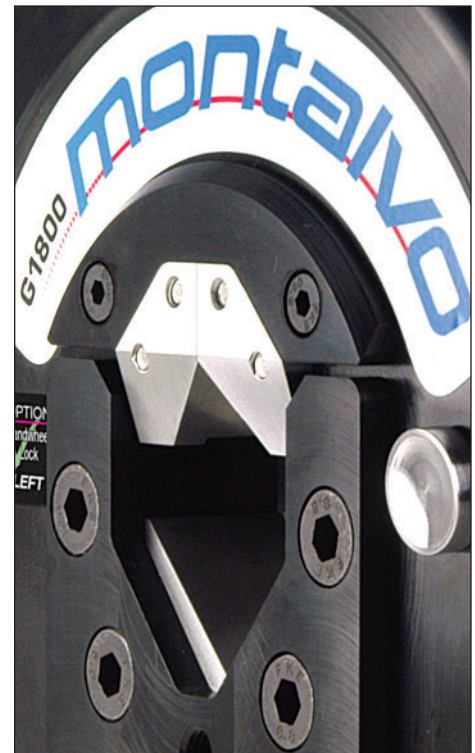

G1800 Flange Mount.



Options

Safety Lock Location (select Left or Right side)

Offers operator comfort and safety. Factory installed. Field reversible.

Axial Carrier

Maintains precise shaft positioning during axial adjustment.

Hand Wheel Open/Closed Indication

Indicates whether hand wheel is open or closed via an electronic sensor.

Hand Wheel Opening Position Indication

Indicates when hand wheel is in precise open position via an electronic sensor.

High Speed Safety Chuck

Handles web speeds in excess of 300 m (980 ft.) per minute. This is achieved by balancing the hand wheel (with safety lock) and shaft.

Conical Chuck Journal Seat

Allows use of simple journals without the risk of excessive stress and wear. This is a cost effective alternative to machining journals with difficult and expensive undercuts. Special Order - contact Montalvo for more details.



Complete hand wheel assemblies ready to install.

Guardian safety chucks with hardened replaceable inserts for A2 and A3 styles.

