



montalvo

HPS Series*

Model HPS 6, HPS 8 & HPS 10 Brakes

Bulletin: 92BHPS610-1EM

Horsepower

Montalvo Brakes are called upon to operate within a wide speed range when used in converting applications. They do not carry "nominal" ratings.

Effective Cooling Speed

Effective Cooling Speed (n_{ECS}) is the speed at which a brake will dissipate a given heat horsepower.

$$n_{ECS} = \frac{2 \times n_{min} + n_{max}}{3}$$

Test Conditions

The curve was generated under the following conditions:

Ambient temp: 13°-16°C
 Humidity: 65 - 70%
 Cast iron bulk temp: 177°C

The brakes were mounted as recommended in the Installation Bulletin on brakes. No guard or cover was used during testing.

Addition of machine guarding, fan or blower cooling, differences in ambient conditions, location, mounting method, etc. will affect heat (kW/H.P.) dissipation capacity of any air cooled brake or clutch. Careful consideration should be given to all conditions surrounding installation. Consult Montalvo for help in application sizing.

This brochure, printed in February 1992, supersedes all previous catalogs, data sheets and specification sheets.

© 1989 Montalvo

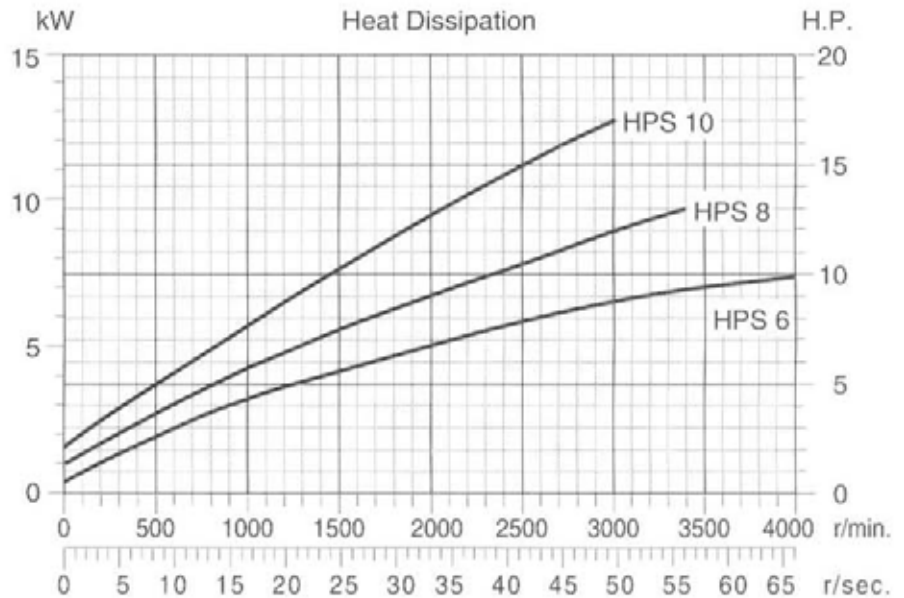

Torque: Max. pair = 5.2 bar ; pair = 0.07 bar

HPS 600	0.10 Coef. Pads		0.30 Coef. Pads		0.45 Coef. Pads	
	Nm		Nm		Nm	
Model	Max	Min	Max	Min	Max	Min
HPS 601	12	0.2	36	0.5	54	0.7
HPS 602	24		72		108	
HPS 603	36		101		162	
HPS 604	48		143		215	
HPS 605	60		179		269	
HPS 606	72		215		323	
HPS 800	0.10 Coef. Pads		0.30 Coef. Pads		0.45 Coef. Pads	
	Nm		Nm		Nm	
Model	Max	Min	Max	Min	Max	Min
HPS 801	15	0.2	44	0.6	66	0.9
HPS 802	29		88		132	
HPS 803	44		132		197	
HPS 804	59		175		263	
HPS 805	73		220		329	
HPS 806	88		264		395	
HPS 807	102		308		461	
HPS 808	117		350		526	
HPS 1000	0.10 Coef. Pads		0.30 Coef. Pads		0.45 Coef. Pads	
	Nm		Nm		Nm	
Model	Max	Min	Max	Min	Max	Min
HPS 1001	17	0.2	51	0.7	77	1.0
HPS 1002	34		101		153	
HPS 1003	51		152		230	
HPS 1004	68		203		306	
HPS 1005	84		253		383	
HPS 1006	101		304		459	
HPS 1007	118		355		536	
HPS 1008	135		405		613	
HPS 1009	152		456		689	
HPS 1010	169		507		766	

HPS 6		
Weight (disc):	Kg	7
Assemb. Wght:	Kg	17
J (disc-hub):	Kgm ²	0.09
Max. n: †	r/sec	71.7
Balance:	gmm	115

HPS 8		
Weight (disc):	Kg	12
Assemb. Wght:	Kg	27
J (disc-hub):	Kgm ²	0.23
Max. n: †	r/sec	56.7
Balance:	gmm	295

HPS 10		
Weight (disc):	Kg	20
Assemb. Wght:	Kg	45
J (disc-hub):	Kgm ²	0.44
Max. n: †	r/sec	48.3
Balance:	gmm	648

† Do not use this figure to calculate drive HP

* Patents applied for

Friction coefficients are nominal. A copy of Application Survey No. 89ASQ-1EIM should be submitted to Montalvo prior to ordering.

Installation dimensions: HPS 10 Series Brakes

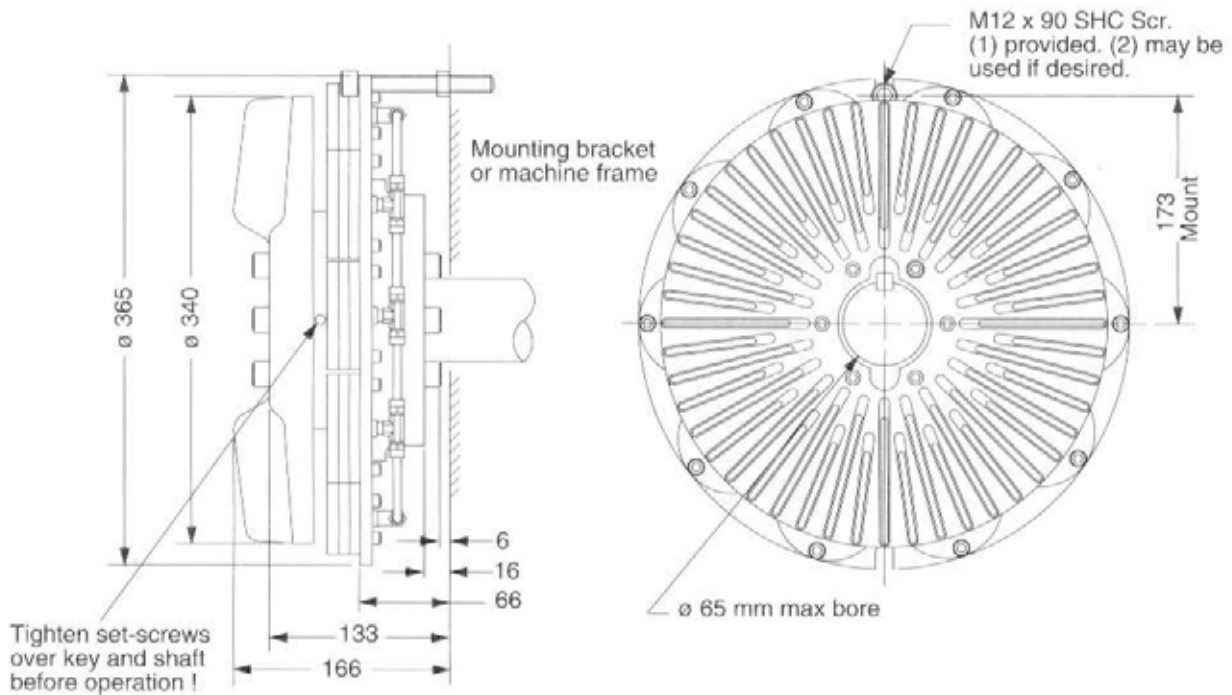

Shaft Preparation

	HPS 6	HPS 8	HPS 10
A	75	81	103
B	18	29	33
C \varnothing max.	40	50	65
C \varnothing min.	30	30	40
D \varnothing max.	45	51	75

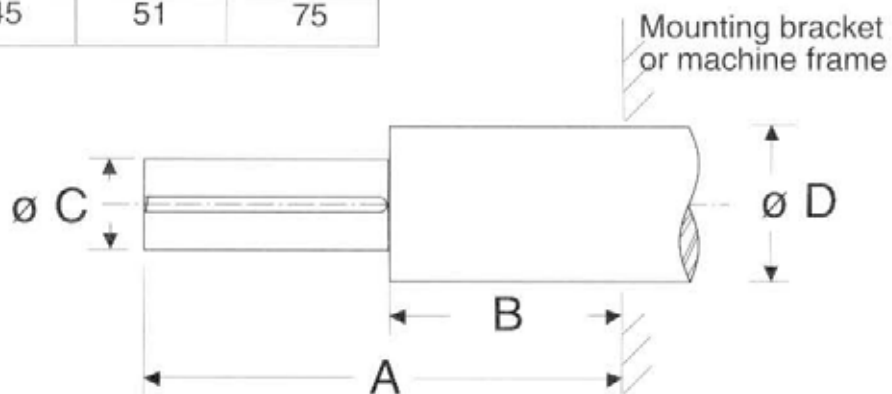

Montalvo's continuing commitment to product improvements make prices and specifications subject to change without notice.

This drawing and the subject matter shown thereby are the exclusive property of The Montalvo Corporation. Reproduction of the drawing in whole or in part and the use of any of the information imparted thereby are strictly prohibited.

All dimensions are expressed in millimeters. Do not scale.

When installing a Montalvo Brake, careful consideration should be given to all conditions surrounding installation. Please consult Montalvo for help in application sizing.

* Open guarding (brake cover) is required in order to allow maximum cooling. Consult Montalvo for dimensional information on brake covers.

It is the customer's responsibility to provide ventilated guards or covers over brakes and clutches in order to comply with safety regulations.

This brochure, printed in February, 1992, supersedes all previous catalogs, data sheets and specification sheets.

montalvo 

No.92BHPS610-1EM