

Length (L)	Overall Length (OAL)
150	190.5
200	240.5
250	290.5
300	340.5
350	390.5
400	440.5

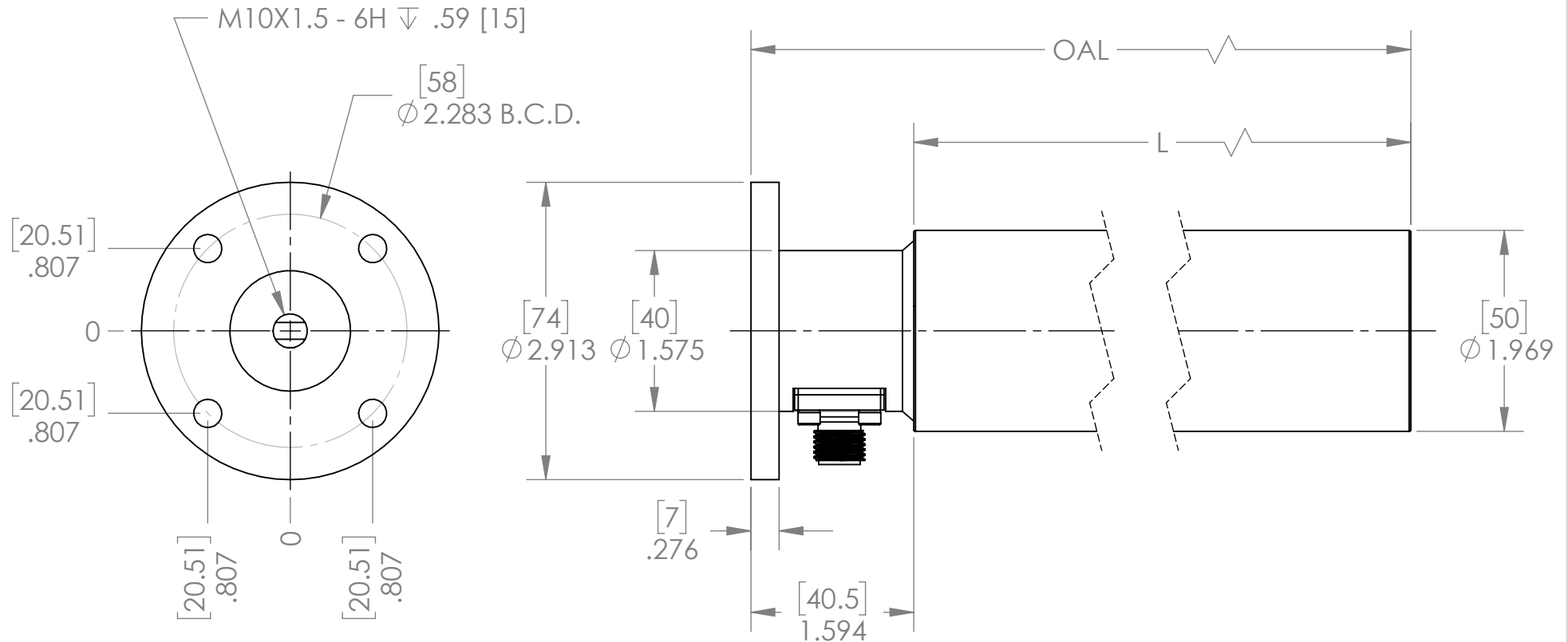

UOS: .00 = \pm .010
 UOS: .000 = \pm .005
 UOS: .0000 = \pm .0005
 UOS: DRAFT ANGLE = 3°
 UOS: ANGULAR: = \pm 1/2°
 UOS: FRACTIONAL: = \pm 1/64
 UOS: FINISH = AS SHOWN

© 2020 **montalvo**
 Better Web Control®
 The Montalvo Corp. 50 Hutcherson Drive Gorham, ME 04038
 info@montalvo.com 1-800-266-8710

PROPRIETARY AND CONFIDENTIAL

© THE MONTALVO CORPORATION 2020
 ALL RIGHTS RESERVED. ANY USE OF THIS DRAWING
 OR THE INFORMATION CONTAINED HEREIN, FOR A
 PURPOSE OTHER THAN AS EXPRESSLY AUTHORIZED
 BY THE MONTALVO CORPORATION OR ITS SUBSIDIARIES,
 IS EXPRESSLY PROHIBITED.

Title: LOAD CELL N2-F

DRWN BY: MT	SIZE	Prt No.	Dwg No.	REV
CHK BY: CAO	A		ref	
DATE: 6/26/2020	SCALE: NONE			SHEET 1 OF 1